

Landing gear for Backpack L



Please read this manual before first use.

Landing gear composition

- 1x front fork
- 1x main frame
- 1x rear axle
- 1x hardware kit
- 1x battery holder plate

not included:

- 1x 77mm / 3in wheel
- 2x 90mm / 3.5in wheel
- Backpack L



Backpack L landing gear Assembling

Assemble the rear axle with the main frame.



Prepare the battery holder plate with 2 CHC M4-30 screws and washers.
Place it on the rear axle as shown on the picture.



Add 2 M4 washers and 2 lock nuts on the back side of the main frame.

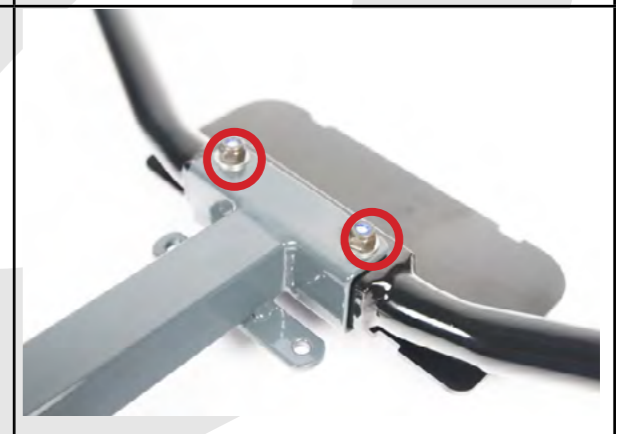

Prepare the front fork with 1 CHC M5-35 screw and 1 M5 golden brass washer.

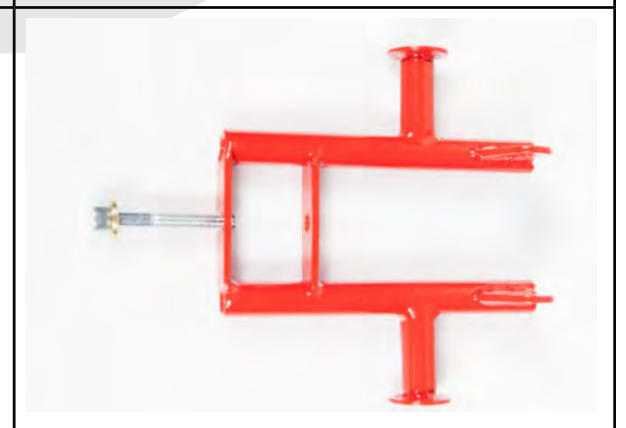

Follow the mounting as described here:

- 1x M5 golden brass washer
- 1x M5 washer
- 1x M5 washer
- 1x M5 lock nut



Drill the 90mm (3.5in) and 77mm (3in) wheel rims with a 5.5mm (0.2165in) drill.



Insert on the 90mm wheels 1 CHC M5-40. And lock it with a M5 lock nut.
Do not screw the lock nut against the wheel rim in order to allow the free rotation of the wheel.



Place 1 M5 washer on the wheel axis.
Then place the wheel axis on the rear axle lower hole. The upper hole is used when the wheel diameter is bigger than 90mm (3.5in).



Lock the wheel axis with 1 M5 washer and 1 M5 lock nut.



Do the same with the second 90mm (3.5in) wheel.



Prepare the front wheel axis with 1 CHC M5-50, 1 M5 golden brass washer and 1 7x7x5.2mm (0.28x0.28x0.2in) spacer.



Mount the 77mm (3in) wheel on the axis. And add the second spacer then lock the mounting with a second M5 golden brass washer and 1 M5 lock nut.



Attach the landing gear with the Backpack L main frame with 4 CHC M4-18 screws, 4 M4 lock nuts and 4 M4 washers.



Tip:

For a better mass distribution, we advise you to firmly attach the battery on the battery holder plate included with the landing gear.