

TWISTER

ELECTRO SAILPLANE



Manufactured by:

TOPMODEL CZ

679 05 HABRŮVKA 100 - CZECH REPUBLIC

www.topmodelcz.cz

e-mail: info@topmodelcz.cz

Order N°: 02098



1100mm

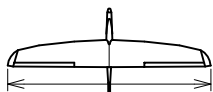

1840mm

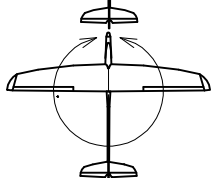

31,7dm²
46-52g/dm²



1,45 - 1,65kg



MH 32

Radio system you'll need :



5channel
with
4 servos



MVVS 4,6/840 Sport



4S Lixx 2-3,3Ah

*Není-li uvedeno jinak, všechny
neoznačené míry jsou v milimetrech
UNLES STATED, ALL DIMENSIONS
ARE IN MILIMETERS*

Part #	Part name	Material, dimensions	Loose	In bag
	building instruction		01	-
1	fuselage	fibreglass	01	-
1-1	engine mount	fibreglass 3 mm	-	01
1-2	servo tray	plywood 4 x 44 x 47 mm	-	01
1-21	elevator servo tray	wood 10 x 10 x 12	-	02
1-3	link support	balsa 5 x 10 x 35 mm	-	01
2	wing	foam core - balsa	02	-
2-1	aileron	foam core - balsa	02	-
24	wing joiner	steel \varnothing 6 x 170 mm	-	01
2-2	wing fixing screw	screw M 4 x 25 mm	-	02
2-21	centering pin	fibreglass \varnothing 3 x 30 mm	-	01
2-3	nut	aluminium M4	-	02
2-31	nut mount	plywood 3 x 40 x 54 mm	-	01
2-4	servo mount	polyurethan 13mm	-	04
2-41	wing servo cover	ABS plastic	-	02
2-5	aileron-flap pushrod	piano wire	-	02
2-6	clevis	MPJ 2110	-	02
2-8	aileron horn	fibreglass plate 1,5 mm	-	02
3	horizontal stabilizer	balsa	02	-
3-2	stabilizer support	plastic	-	01
3-3	axle	piano wire \varnothing 3 x 14 mm	-	01
3-4	stabilizer fixing screw	nylon M 4 x 11 mm	-	01
3-5	elevator link	piano wire M2 L= 200mm	-	01
3-6	screw-lock pushrod connector	MPJ 2762	-	01
3-7	clevis M 2 + nut M 2	MPJ 2140	-	01+01
4	fin	balsa assembly	01	-
4-3	closing strip	balsa 5 mm	-	01
4-5	rudder link	external bowden L= 530mm, internal bowden L=590mm, piano wire \varnothing 0,8 mm L= 590mm	01+01+ 01	-
4-6	clevis	MPJ 2110	-	02
4-65	screw-lock pushrod connector	MPJ 2762	-	01
4-7	threaded coupler	MPJ 2012	-	01
4-8	rudder horn	fibreglass plate 1,5 mm	-	01
6	canopy	fibreglass	01	-
6-2	canopy fixing	fibreglass \varnothing 2 x 150 mm	-	01
6-21	mount	plywood 3 x 6 x 12 + 4 x 6 x 12mm	-	01+01
7	stickers		07	-
11	pinned hinge	MPJ 2502	-	02

RECOMMENDED EQUIPMENT:

		Pieces		Item No www.topmodelcz.cz
Transmitter	4 channel			
Receiver	5 channel			
Servo	HS-82 MG	2	ailerons	1hi7297
	MS2414	1	rudder	0202414
9mm servo	Slim Servo SS1816	1	elevator	0201816
Motor	MVVS 4,6/840 SPORT	1		#2049
Controller:	XREG 60	1		099REG60
Spinner:	spinners for folding props 40/5/8	1		0201521
or	turbo for folding props 40/5/8			0201559
Propeller:	CAM CARBON 12/8"	1		723450
	CAM CARBON 11/10"		for higher speed	723443
Battery:	Hyperion G3 VX - 4S 3300mAh (35C)			HP-LG335-3300-4S

ATTENTION:

This model construction kit is not a toy and is not suitable for children under the age of 14.

Incorrect use of this material could cause material damage or person injury.

You are fully responsible for your actions when you use this model.

Fly at a safe distance from occupied zones. Be sure that no one else is using the same frequency as you.

Before first take-off check up please if model aeroplane parts aren't crooked.

The reparation is possible through the use of hot-air dryer.

CZ Seznam dílů

Položka	Název dílu	Materiál, rozměr	Volně / ks	Balíček/ ks
	montážní návod		01	-
1	trup	laminát	01	-
1-1	motorová přepážka	sklotextit 3 mm	-	01
1-2	držák serva směrovky	překližka 4 x 44 x 47mm	-	01
1-21	držák serva výškovky	lípa 10 x 10 x 12mm	-	01
1-3	držák bowdenu	B 5 x 10 x 35 mm	-	01
2	křídlo	polystyren-balsa	02	-
2-1	křídélko	polystyren-balsa	02	-
24	spojka křídla	ocel Ø 6 x 170 mm	-	01
2-2	uchycení křídla	šroub M 4 x 25 mm	-	02
2-21	aretační kolík	laminát Ø 3 x 30 mm	-	01
2-3	uchycení křídla	matice AL. M4	-	02
2-31	podložka matice	překližka 3 x 40 x 54	-	01
2-4	držák serva	polyuretan 13mm	-	04
2-41	krytka serva	ABS folie	-	02
2-5	táhlo křídélka a klapky	ocel	-	02
2-6	koncovka táhla	MPJ 2110	-	02
2-8	páka křídélka	sklotextit 1,5 mm	-	02
3	výškovka	balsa	01	-
3-2	lože výškovky	plast	-	01
3-3	čep lože	ocel Ø3mm L = 14mm	-	01
3-4	šroub výškovky	plast M4 x 11mm	-	01
3-5	táhlo VOP	ocel M2 L = 200mm	-	01
3-6	koncovka táhla	MPJ 2762	-	01
3-7	vidlička kovová, matice M2	MPJ 2140	-	01+01
4	směrovka	balsa konstrukční	01	-
4-3	steven	b 5	-	01
4-5	táhlo směrovky	bowden Ø3mm L = 530mm bowden Ø2mm L = 590 ocel. drát Ø0,8mm L = 590mm	01+01+01	
4-6	koncovka táhla	MPJ 2110	-	01
4-65	koncovka táhla	MPJ 2762	-	01
4-7	spojka táhla	MPJ 2012	-	01
4-8	páka směrovky	sklotextit 1,5 mm	-	01
6	kabina	laminát	01	-
6-2	uchycení kabiny	laminát Ø2 x 150 mm	-	01
6-21	podložka	př. 3 x 6 x 12 + 4 x 6 x 12	-	01+01
7	obtisky		07	
11	závěsy kormidel	MPJ 2502	-	02

DOPORUČENÉ PŘÍSLUŠENSTVÍ :

		kusů		objednáací číslo www.topmodelcz.cz
Vysílač	4 kanál			
Přijímač	5 kanál			
Servo	HS-82 MG	2	křídélka	1H13040
	MS2414	1	směrovka	0202414
	SS1816	1	výškovka	0201816
Motor	MVVS 4,6/840 SPORT	1		#2049
Regulátor	XREG 60	1		099REG60
Kužel	40/5,0/8	1	klasik	0201521
nebo	TURBO 40/5,0/8		náhrada Klasik kuželu	0201559
Vrtule	CAM CARBON 12/8"	1		723450
	CAM CARBON 11/10"		pro vyšší rychlost	723443
Akumulátory:	Hyperion GX V3 - 4S 3300mAh (35C)	1		HP-LG335-3300-4S

Před prvním startem zkontrolujte jestli nejsou díly modelu zkroucené. Náprava je možná pomocí horkovzdušné pistole .

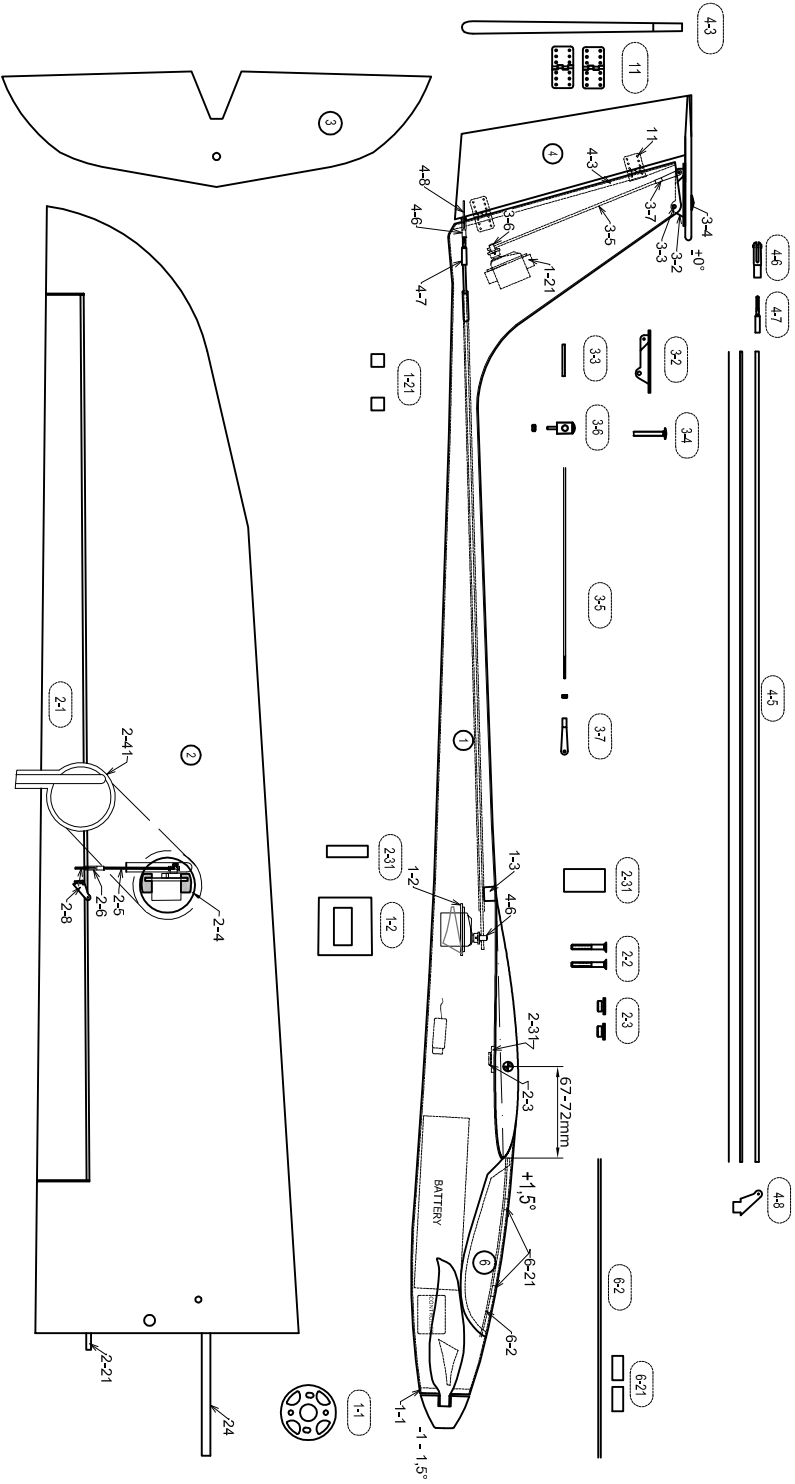

TWISTER

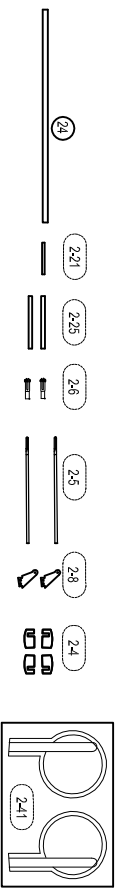

© XII. 2010 TOPMODEL CZ Manufactured by TOPMODEL CZ s.r.o. 679 05 HABRŮVKA 100 - Better made in the Czech Republic
 www.topmodelcz.cz e-mail: info@topmodelcz.cz

SPODNÍ STRANA
BOTTOM

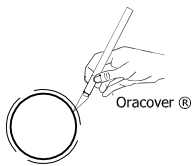

②

Oracover ®

spodní + horní strana
bottom + top

Oracover ®

SPODNÍ STRANA
BOTTOM

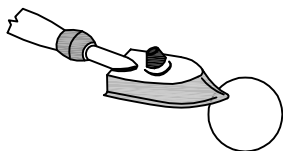

Oracover ®

②

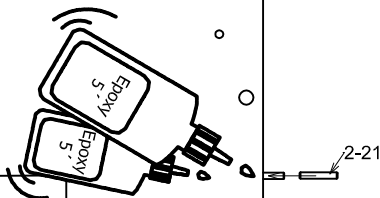

2-21

krok 1.
step 1.

páska
tape

krok 2.
step 2.

páska 2
tape

VRCHNÍ STRANA
TOP

②

1/2
1/2

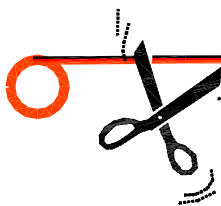

~370mm - 2x

pro servo křidélek
for aileron servo



SPODNÍ STRANA
BOTTOM

②



NEUTRAL

2-4

SPODNÍ STRANA
BOTTOM

Ø1 pro 2-8
Ø1 for 2-8

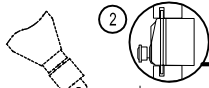

2-1

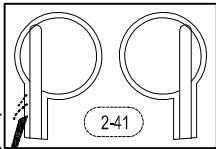
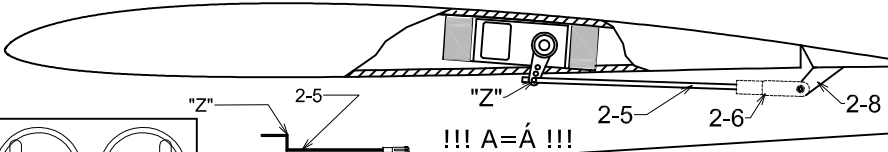
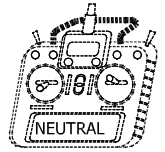
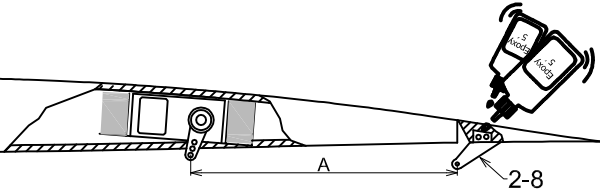

2-41

SPODNÍ STRANA
BOTTOM

2

kontaktní lepidlo (Chemopren)
dry-bond adhesive

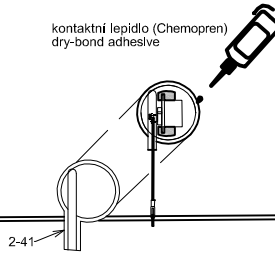

2-41

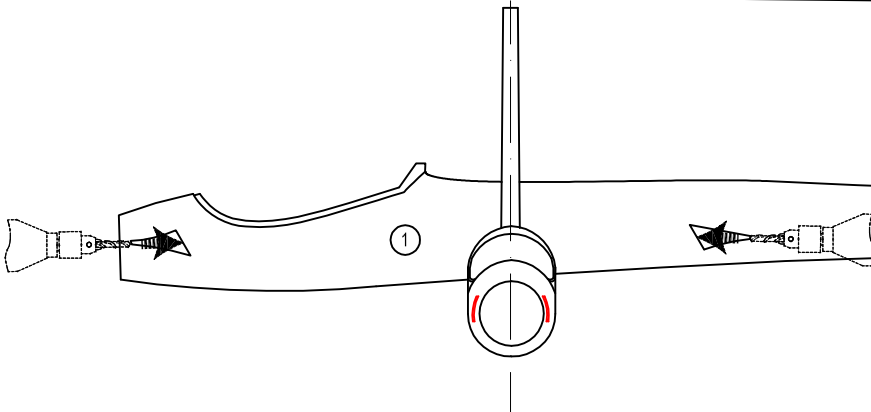

1

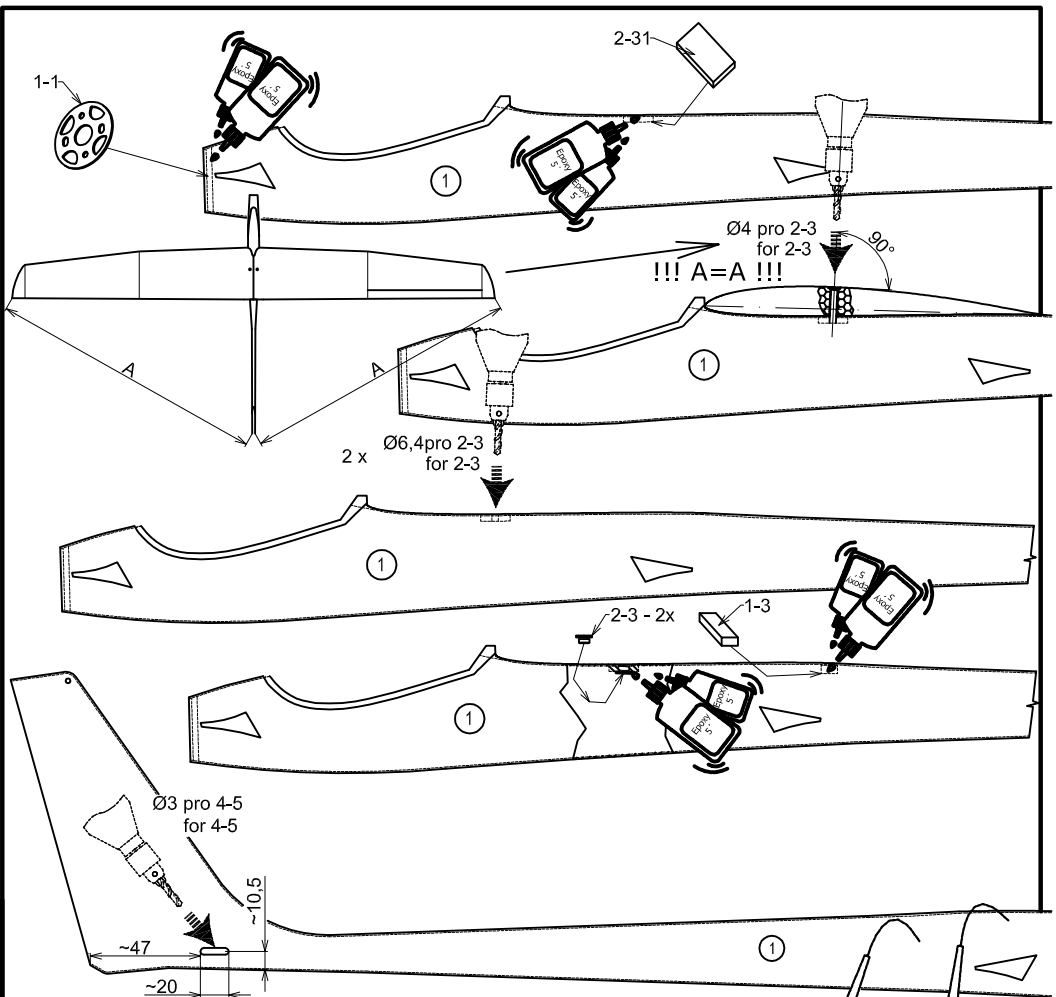

pro servo výškovky
for elevator servo

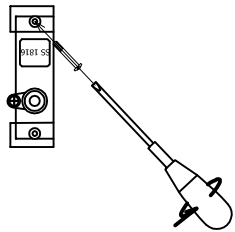
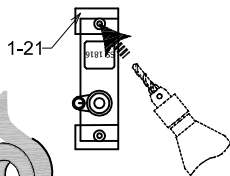
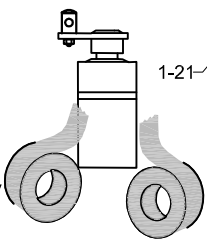
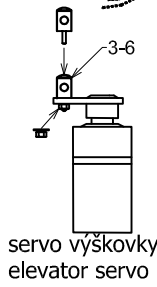
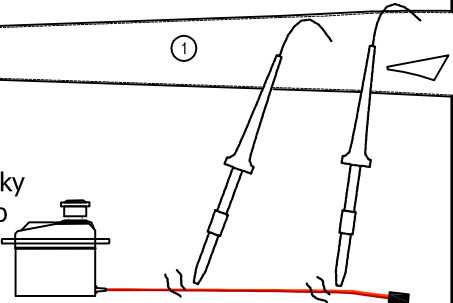

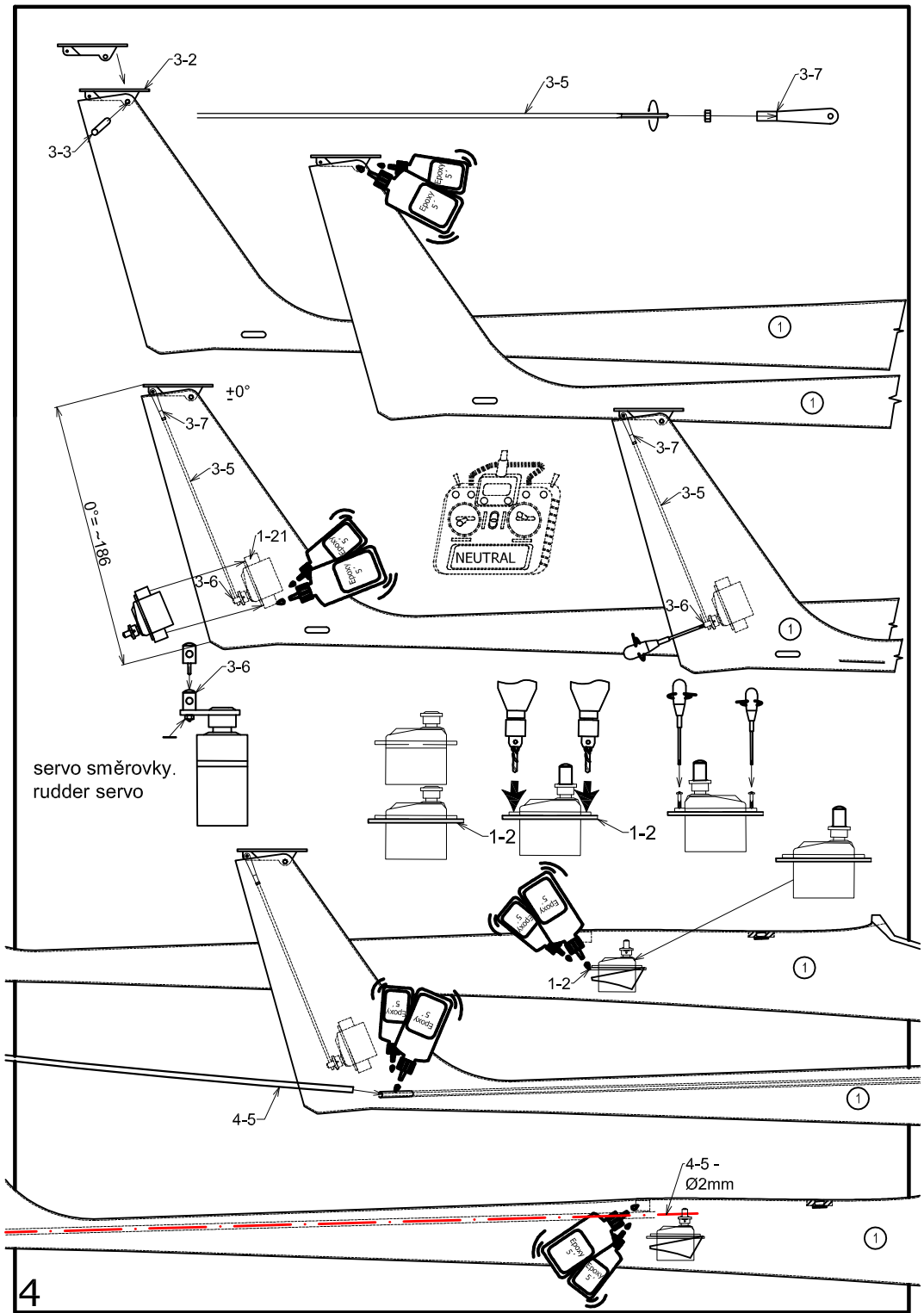

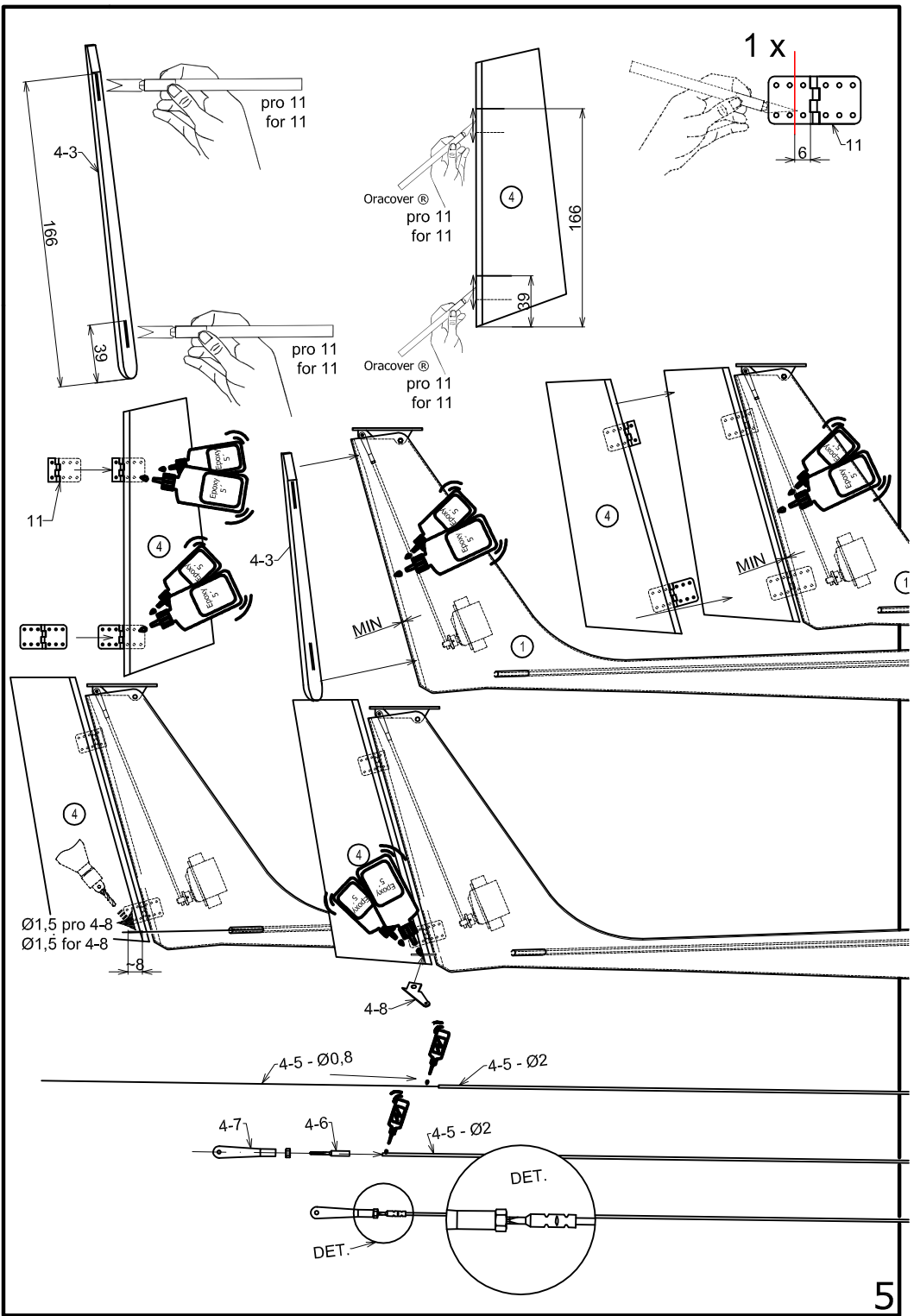

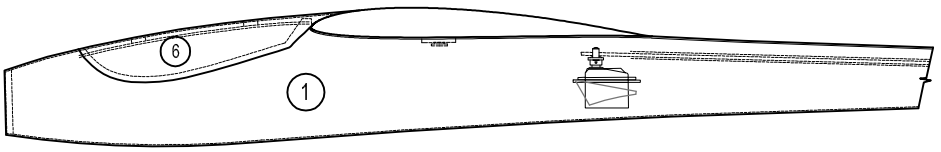
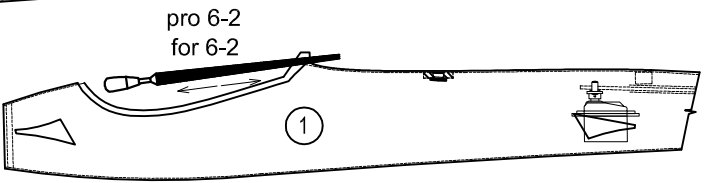
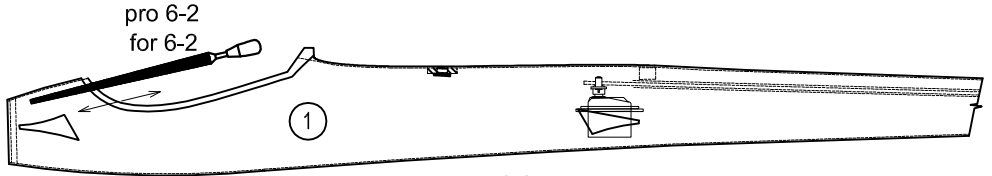
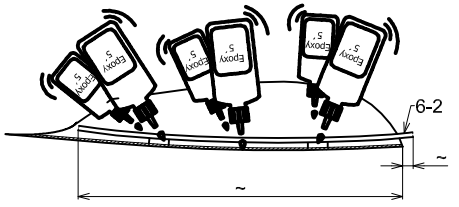
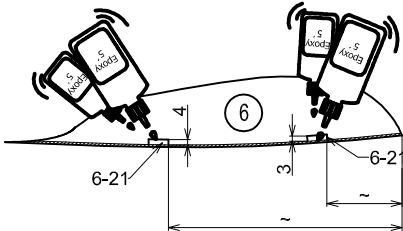
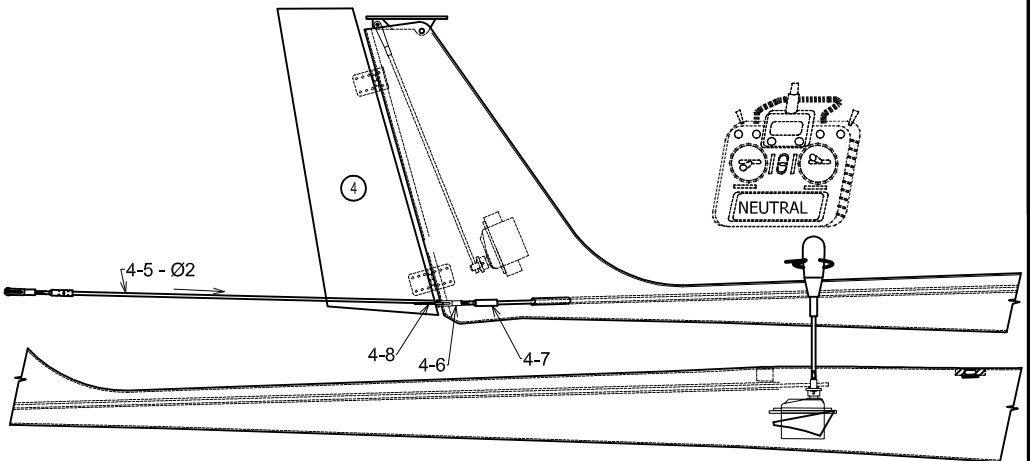

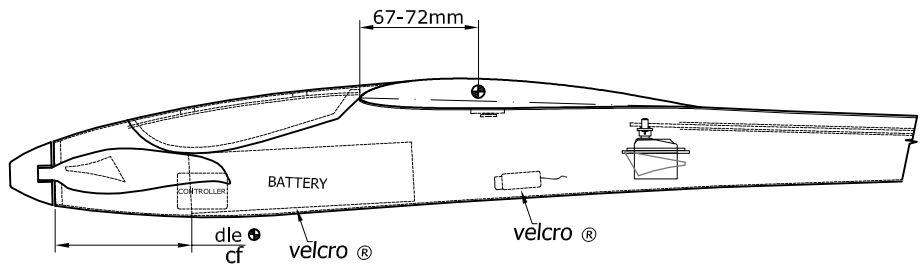
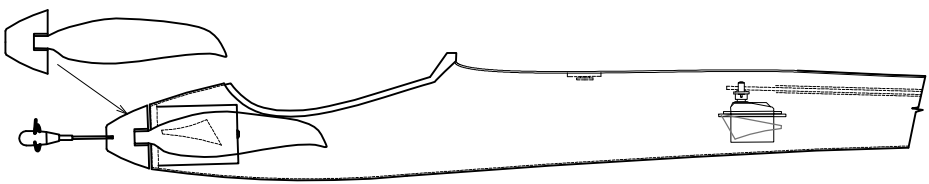
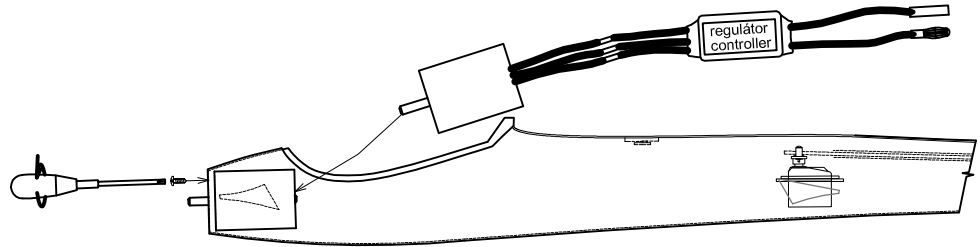
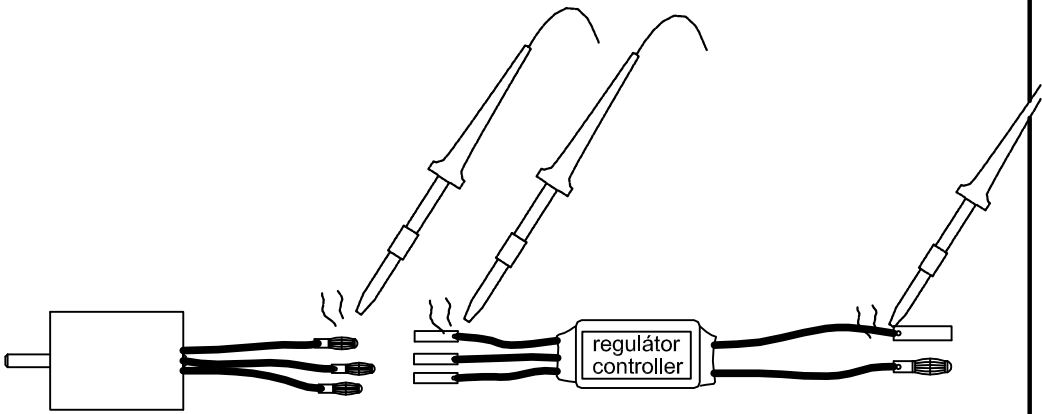

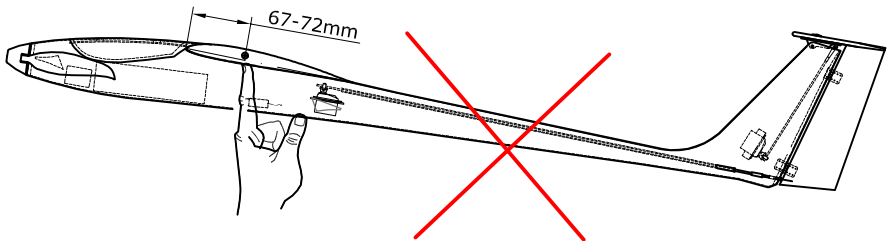
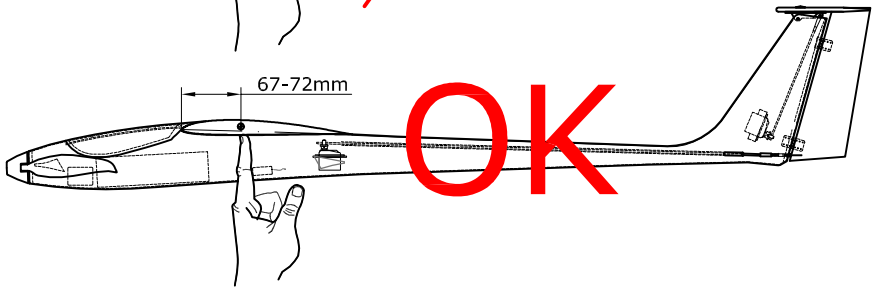
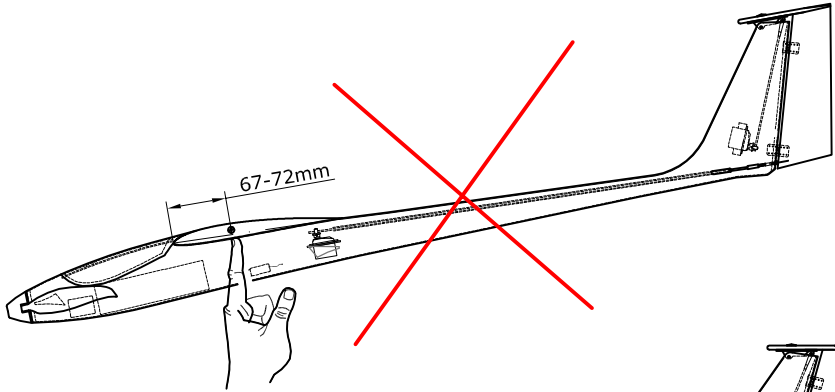
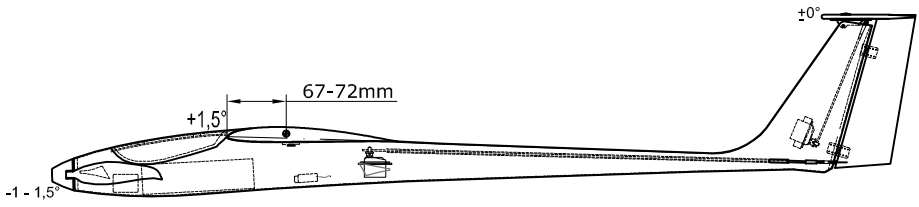

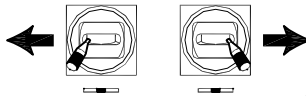
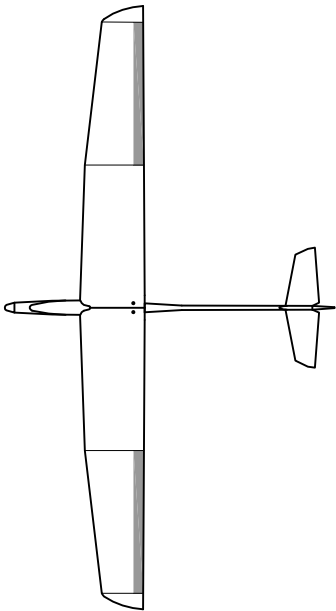

↑ Přistání - 15 - 18mm
Landing

15 - 18mm

EXPO 25 - 30%

7 - 9mm

↓ Termika - 5mm
Thermik

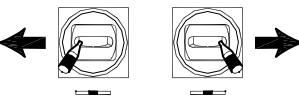

25 - 28 mm

EXPO 20%

25 - 28 mm

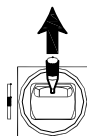
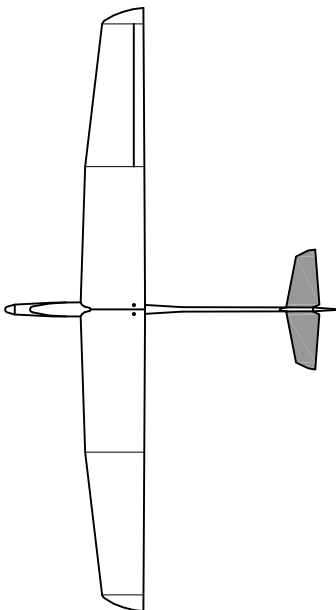

9 - 11mm

EXPO 10%

9 - 11 mm

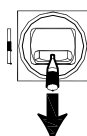

↓ Přistání - 0,5-0,7mm
Landing

